



11, Paddock Road, Bexleyheath DA6 8NF
Guide Price £425,000



Guide Price £425,000 - £450,000

This three-bedroom terraced home enjoys a prime position on Bexleyheath's popular south side, just a short walk from the Broadway shopping centre, Danson Park, and a range of highly regarded schools—including Townley Grammar. Well-connected for commuters, it offers easy access to Bexleyheath station, the 'Superloop' bus service to Abbey Wood and the Elizabeth Line, along with excellent local transport links.

Ideal for first-time buyers, the property is well presented and features a welcoming entrance hall, a comfortable reception room, and a fitted kitchen/diner. Upstairs are three bedrooms and a contemporary family bathroom. Further highlights include double glazing, gas central heating, front and rear gardens, and a garage en bloc.

Local Authority: {prop_LA_county}

Council Tax Band: {council_tax_band}



01322 553322

60-62 High Street, Bexley, Kent, DA5 1AH

bexley@parkestates.co.uk
www.parkestates.co.uk

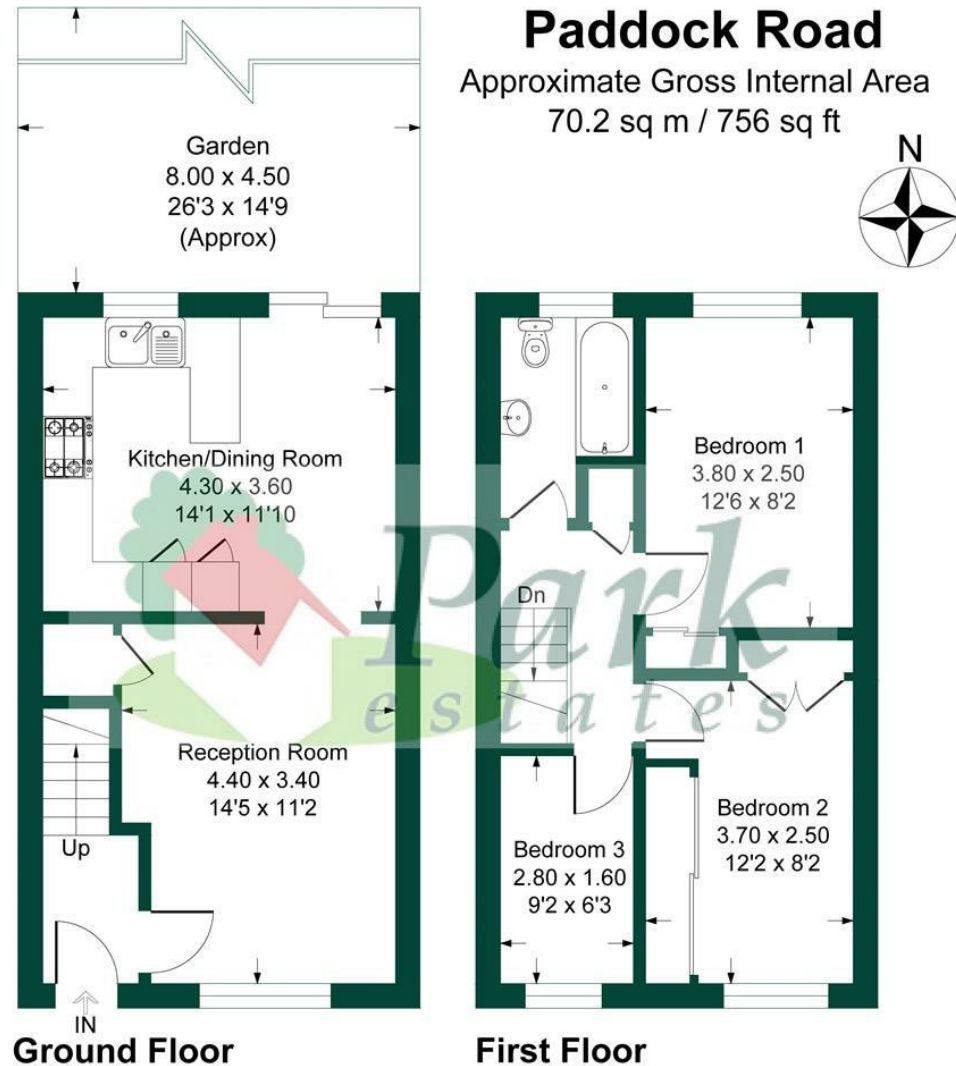

This plan is for layout guidance only. Not drawn to scale unless stated. Windows and door openings are approximate. Whilst every care is taken in the preparation of this plan, please check all dimensions, shapes and compass bearings before making any decisions reliant upon them.
Produced By Planpix

Every care has been taken with the preparation of details, but accuracy is in no way guaranteed. These particulars do not constitute a contract and are issued and accepted on the express understanding that all negotiations will be conducted through Park Estates. The seller does not make or give, nor do we or our employees have any authority to give a representation or warranty in relation to the property. Please contact this office before viewing the property. If there is any point which is of particular importance to you, we will be pleased to check the information for you and confirm that the property remains available. This is particularly important if you are contemplating travelling some distance to view the property. We would strongly recommend that all the information that we provide about the property is verified by yourself on inspection and also by your conveyancer, especially where statements have been made by us to the effect that the information provided by us has not been verified.